

DOOR

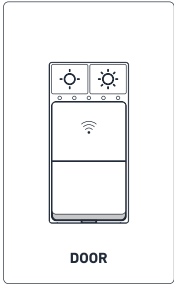

Dimmer Switch

Quick Start Guide 2024

Door.com

A Welcome!

Thank you for choosing **DOOR** products!

At **DOOR** we're reinventing how we live. Through the foundation of access control business, we serve the Honest Day's Worker—the builder, property manager, contractor, driver, and in-home service provider—that keeps the world running smoothly.

These individuals are the cornerstone of vital services such as housing, transportation, cleaning, dog walking, and more. They deserve access to technology and products that empower them to provide top-notch experiences to their customers while maximizing the economic benefits of their hard work.

DOOR is proud to stand by and innovate for our Honest Day's Worker every day!

B Before You Begin

The **Dimmer Switch** is generally compatible with the following light bulb types, at their respective maximum loads:



LED
150 Watts



Fluorescent/CFL
150 Watts



Halogen
450 Watts



Incandescent
450 Watts

Please note the following user guide icons:



Very important information, please read carefully



Good to know, helpful tips for installation



This device connects to the internet via **DOOR Field Station**, and it does not connect directly to your WiFi or local network. In order for remote access to the device from the app, and for full functionality, a **DOOR Field Station** is required.

This guide assumes the **DOOR App** has been installed on your smartphone and a **Field Station** is installed and online.



Do NOT overload or use your Dimmer Switch to control receptacles, motor-driven appliances, or transformer-supplied appliances.

Review the environmental limitations of the **Dimmer Switch** prior to installation.

The **Dimmer Switch** is intended for indoor locations, only!

B Before You Begin



Ensure that you are comfortable working with electricity and handling the associated tools, or hire a qualified electrician to install your Dimmer Switch!

The **Dimmer Switch** requires a neutral wire! It will not function without a neutral wire. As explained in the Installation section, you must identify the neutral wire in the switch's electrical box. If a neutral wire is not present, one must be installed. Consult with or hire a qualified and properly licensed electrician, as required.



The **Dimmer Switch** is not compatible with 3-way switches or 3-way style wiring, but 3-way operation functionality can be accomplished using two **Dimmer Switches**, wired as standard switches, and paired using Control-D2D pairing. This pairing process is explained in the Control-D2D pairing section of this user guide.

C In the Kit

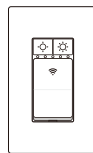

Dimmer Switch

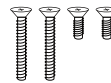

Faceplate Screws (2)
& Electrical Box
Screws (2)



Wire
Connectors (4)

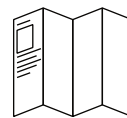

Quick Start Guide

D Required Items

The following items may be required:

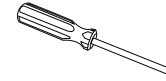

Medium Phillips
Screwdriver

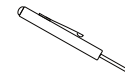

Small Slotted
Screwdriver



Wire Strippers or
Cutters



Multimeter

E Get to Know Your Device

Brightness Decrease Button

- **Short press** to decrease the brightness in order 100%->80%->60%->40%->20%
- **Long Press** to decrease by 1%

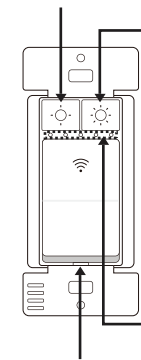

Brightness

Increase Button

- **Short press** to increase the brightness in order 20%->40%->60%->80%->100%
- **Long Press** to increase by 1%

Brightness LEDs

Indicates the current lighting brightness
20%-40%-60%-80%-100%

Status LED

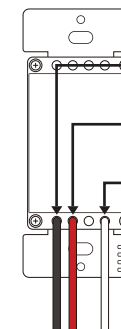

Live

Load

Neutral

Ground

E Get to Know Your Device

LED Behaviors



Blinking Red Once, then Green Once
Device Start-up



Blinking Red And Green Alternately
Restoring to Factory Defaults



Red
Dimmer is off



Green
Dimmer is on



Blinking Green
Connecting to Cloud



Slow Blinking Green
Updating



Fast Blinking Green
Pairing Device to Device



Fast Blinking Red
Unpairing Device-to-Device

F Add Device To DOOR App

If you are new to **DOOR**, please install the **DOOR App** on your phone, if you have not already.



Open the app and tap **Sign up** for an account. You will be required to provide a username and a password. Follow the instructions, to set up a new account. Allow notifications, when prompted. **Log in** to the app using your new username and password. If you already have an account, please ensure you log in using that one.

Ensure you install the **Field Station** within the app before proceeding to install the **Dimmer Switch**.

F Add Device To DOOR App

- 1 In the Home screen of the app, tap on the card located in the top right.



- 2 Tap on the "Add device" icon.

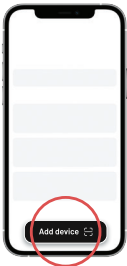

- 3 Approve access to your phone's camera, if requested. A viewfinder will be shown on the app.

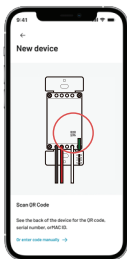

- 4 Hold the phone over the QR code so that the code appears in the viewfinder. If successful, the next steps will be displayed.

- 5 Follow the on-screen instructions in the **DOOR App**, which will guide you step by step.

G Installation

1. Turn off the circuit that serves the switch at the circuit breaker panel (or other means of disconnecting the AC power to the circuit). Do NOT work on "hot" electrical wiring! Verify that power has been removed to the light switch, by testing the switch, and by using a multimeter or other type of voltage tester before removing any wires from the switch.

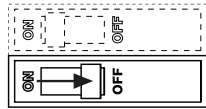

If replacing an existing switch, proceed to the next step. For new installations, skip ahead to step 8

2. Using a slotted screwdriver, remove the switch faceplate, then using a slotted or Phillips screwdriver, remove the switch and pull it away from the wall. Retain the screws; do not discard.

3. Before removing any wiring from the switch, identify the wires on the switch and in the electrical box:

Ground wire: this wire is typically a bare copper wire, but it may have a green jacket (insulation), or it may have another color insulation with green tape identifying it as a ground. Additional means of identification are the wire is terminated on (connected to) a green screw on the switch, and/or the screw or wire connection has a designation such as "GND" and/or includes the universal earth ground icon:



Line or Hot Wire: this wire is typically black, but can be red or another color, but if not it may be marked as the hot wire with black or red tape. One of the wires on the existing light switch should be the hot wire. Another way of identifying this wire is that it may be connected to other wires in the box. If the box contains multiple switches, for example, there will typically be a hot wire that connects to each switch. Observe each of the non-ground wires on the switch, looking for connections to other black (or red) wires under a "wire-nut" or similar wire connector.

6. Prepare to terminate (connect) the wires to the **Dimmer Switch**. Refer to Figure 1. The following wires should have been removed from the existing switch, ready to terminate on the new switch:

Ground wire
Switch leg wire (to light/lights)
Hot/Line/Live wire

If there are multiple neutral wires in the box, as shown in **Figure 1**, you may need to furnish a jumper wire, to connect the neutral wires to the **Dimmer Switch**. If you do not have wire on hand, if there is enough spare length or slack in the wires, you may be able to cut off a short section, to make a jumper wire.

7. Each wire must have the end stripped (insulation removed) approximately 1/2 inch, and straight. Straighten or trim off any bare wire loops that were used on the existing switch.



8. Terminate the wiring on the **Dimmer Switch**. Insert the respective wire into the appropriate screw terminal on the switch:

Neutral wire in Neutral terminal
Hot/Live wire in Live terminal
Switch leg/light wire in Load terminal
Ground wire in Ground terminal

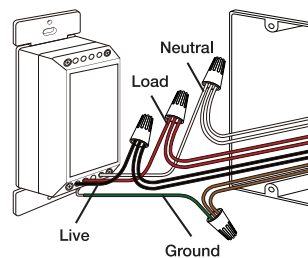
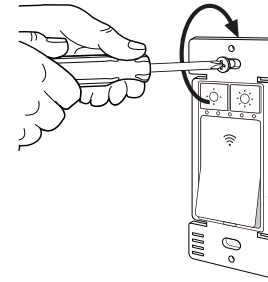

Figure 1

9. Check each wiring connection by gently tugging on each wire, ensuring it does not pull out of the screw terminal or appear loose. Redo any that do not pass this test.

10. Gently push the wiring and the switch into the electrical box. Then, using the original or included screws, secure the **Dimmer Switch** to the box.



11. If your **Dimmer Switch** is installed in a multi-gang box, save or discard the decorative trim plate. Otherwise, snap the plate over the switch, snap the plate over the switch.

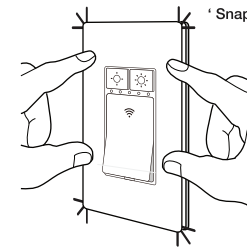

12. Turn on power to the circuit by returning the circuit breaker to the on position (or reconnect power per your applicable circuit disconnection method).

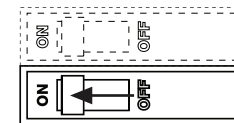

13. Test the switch by turning it off and on and verifying the lights turn off and on with it.

14. Check the status of the switch in the app. It should be indicated as online.

H Contact Us

DOOR

Support
support@door.com

Door Technologies, Inc.
www.door.com
1220 N Price Rd
STE 2
Olivette, MO 63132

Copyright © 2024
Door Technologies, Inc.
All rights reserved.

To install and configure devices
download the **DOOR App**:

